

PUSH BUTTON SWITCH

CONNECT YOUR LIFE...

**HIGH QUALITY
SAFETY QUARANTEED**

ROCKER SWITCH

RONG FENG INDUSTRIAL

SS-160-B (DPST)

Rating: 10A 250V AC TV-8
Approvals: UL/CSA

Rating: 10A 250V
Approvals: VDE/ENEC

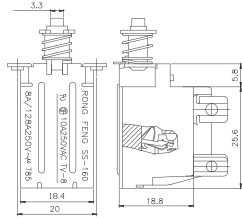

SS-160-B

SS-160-PCB (DPST)

Rating: 10A 250V AC TV-8
Approvals: UL/CSA

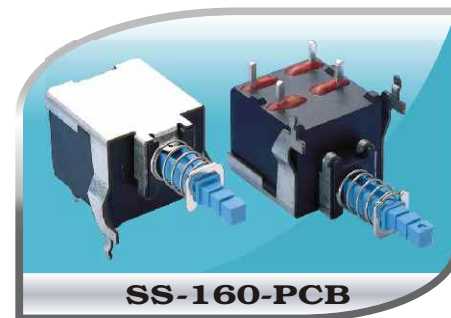
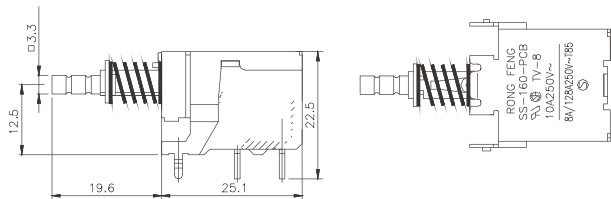

SS-160-PCB

SS-160-3 Series (DPST)

Rating: 5A 250V AC TV-5
Approvals: UL/CSA

Rating: 5A/80A 250V AC
Approvals: VDE/ENEC

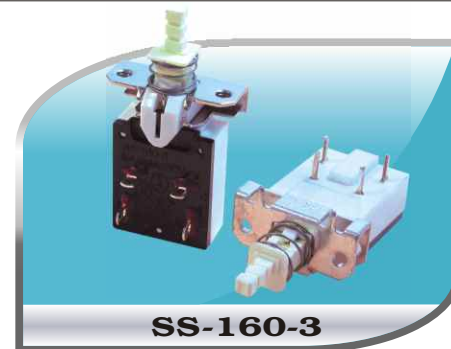
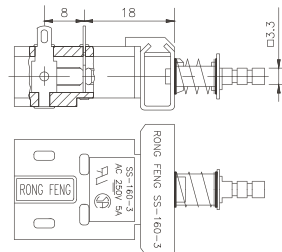

SS-160-3

SS-160-7 Series (SPST)

Rating: 10A 250V/15A 125V AC TV-8
Approvals: UL/CSA

Rating: 8A/128A 250V AC T85
Approvals: VDE

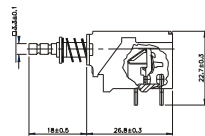

SS-160-7

SS-160-9 Series (SPST)

Rating: 10A 250V AC TV-5
Approvals: UL/CSA

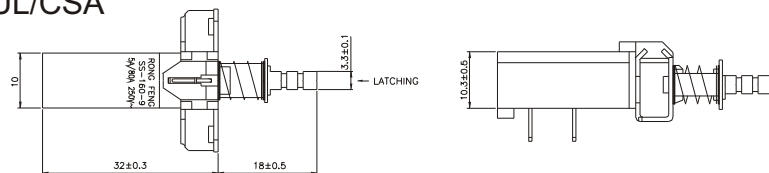

SS-160-9

RF-1001 Series (SPST)

Rating: 10A 250V AC
15A 250V AC
Approvals: UL/CSA/BSMI



RF-1001

RF-1003 Series (SPST or DPST)

Rating: 10A 250V AC 1/3HP TV-5
Approvals: UL/CSA

Rating: 8A/90A 250V AC T85
10(4) A250V ACT85
Approvals: VDE/NEMKO/CQC/KTL



RF-1003

RF-1003C Series (SPST)

Rating: 12A 250V AC TV-5
Approvals: UL/CUL

Rating: 12A 250V AC 5A/80A 250V AC
Approvals: TUV/CCC



RF-1003C

RF-1004 Series (DPDT or DPST)

Rating: 16A 250V AC 1/4HP 125V 1/3 HP 250VAC
Approvals: UL/CSA

Rating: 16(4)A 250V AC 1E4 T85/55
10(4)A 250V AC 5E4 T85/55
Approvals: VDE/NEMKO/KTL/CCC



RF-1004

RF-1003B Series (SPST or DPST)

Rating: 10/16A 125/250V~
Approvals: UL/CUL

Rating: 10(4)A/16(4)A 250V AC
Approvals: TUV

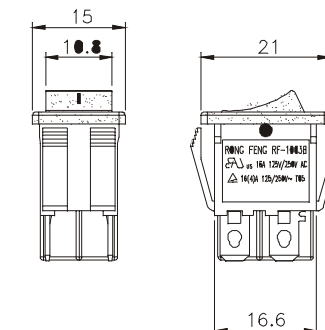

RF-1003B

ROCKER SWITCH

CONNECT YOUR LIFE...

**HIGH QUALITY
SAFETY QUARANTEED**

ROCKER SWITCH+
SUPPLEMENTARY
PROTECTOR

VOLTAGE SELECTOR

RONG FENG INDUSTRIAL

RF-1006 Series (SPST)

Rating: 10A 250V AC
15A 125V AC
Approvals: UL/CSA

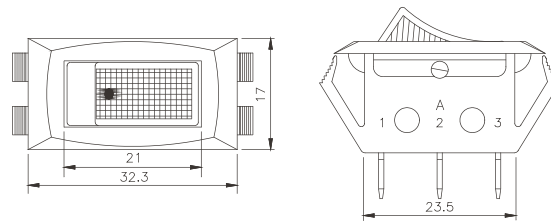

RF-1006

RF-1005A Series

Standard: UL 1077
Rating: 13A-15A 125V AC
Approvals: UL/CSA

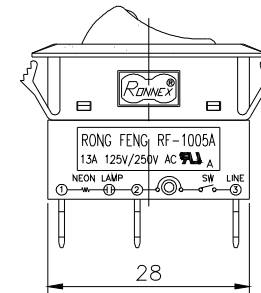

RF-1005A

RF-1002 Series (DPST or DPDT)

Rating: 12A 125V/250V
Approvals: UL/CSA

Rating: 10(1)A 250V AC T85
Approvals: VDE



RF-1002

RF-1007 Series (SPST)

Rating: 10A 250V AC
15A 125V AC



RF-1007

RF-1008 Series (SPST)

Rating: 10A 250V AC
Approvals: VDE/ENEC
Rating: 15A 250V AC
Approvals: UL/CSA

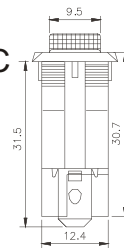

RF-1008

RF-1009 Series (DPST)

Rating: 16(4)A 250V AC
Approvals: VDE/ENEC/KTL



RF-1009

RF-1005B Series

Standard: UL 1077
Rating: 7-16A 125/250V AC
Approvals: UL/CUL/TUV

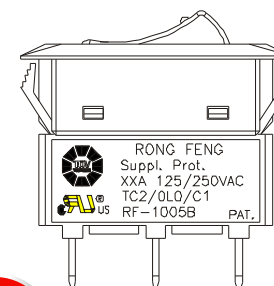

RF-1005B

RF-1002A Series (SPST or SPDT)

Rating: 12A 125V/250V
Approvals: UL/CSA

Rating: 10(1)A 250V AC
Approvals: VDE/CQC



RF-1002A

RF-1002B Series

Rating: 12A 125V/250V
Approvals: UL/CSA
Rating: 10(1)A 250V AC T85
Approvals: VDE/NEMKO

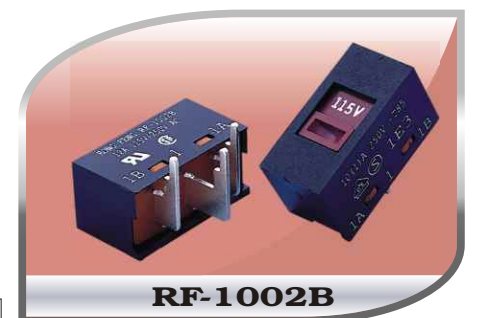
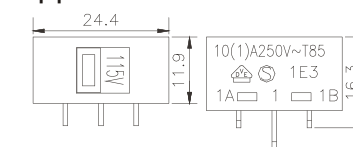

RF-1002B

RF-1033 Series (SPST or SPDP)

Rating: 6A 250V/10A 125V AC
Approvals: UL/CSA

Rating: 6(2)250VAC
Approvals: VDE/ENEC

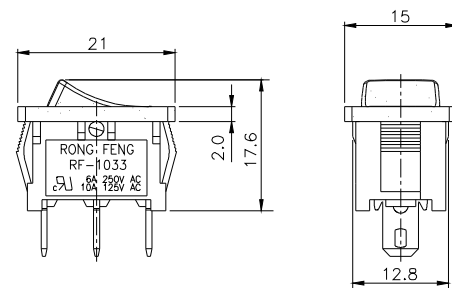

RF-1033

RF-1002C Series (SPST or SPDT)

Rating: 12A 125V/250V
Approvals: UL/CSA

Rating: 10(1)A 250V AC
Approvals: VDE

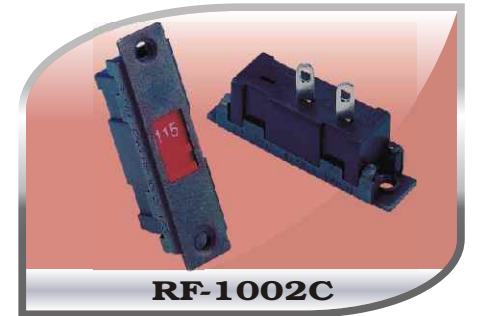
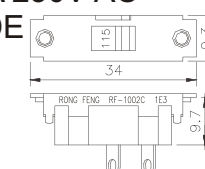

RF-1002C